



Jiang Te Polytron Technologies Inc.
German Technology Imported Raw Material



PE GAS PIPE & FITTING



江特股份
股票代码: 838639



Company Profile

Established in 1999, Jiang Te Polytron Technologies Inc. is a professional production factory of HDPE water pipes and pipe fittings (Butt fusion fittings & socket fusion fittings), Gas pipe and pipe fittings (electrofusion fittings & Butt fusion fittings), PP-R pipes (white or green color) and fittings, HDPE Pipe fitting can be made up to O.D.1200mm by injection moulding machine.

The company owns existing park nearly 60,000 m², production plants of 40,000 m², over 300 employees, including more than twenty professional technical engineers, the company has near 26 sets injection machines, 31 extrusion lines (Battenfeld-cincinnati and KraussMaffei included), our max size of HDPE pipe is up to 1200 mm. The company's capacity of all series of products is up to 200,000 tons per year.

Furthermore, we have achieved BV, CE, ISO 9001:2000, ISO 14001:2004, OHSAS18001 occupational health certifications. Our products are also exported to clients in such countries and regions as Italy, the Kingdom of Morocco, Spain, Russia, Oman, Kazakhstan, Peru, Indonesia, Yemen, Korea and so on. The company is Located in Qingyang, Jiangyin, Jiangsu, China, which is only 40 minutes from Shanghai train station and two hours from Shanghai PVG international airport. We warmly welcome domestic and foreign customers to visit our company for guidance, exchanges and cooperation, join us to make more contributions to promote the plastic pipe industry.

1. Designed for the highest pressure rate. Maximum safety of pipe network system.
2. The use of [CNC post copper wire laying technology](#) for electro fusion fittings can make sure the inner hole is round and complete enough for easy and stable installation.
3. Electro fusion fittings have [observation holes](#) to avoid spraying PE melt during welding process.
4. Using [copper alloy resistance wire](#) to guarantee the welding performance of electro fusion fittings.
5. Using [seamless steel pipe](#) for all Steel/Plastic Transition Joints.
6. Processed by CNC machine tools, higher dimensional accuracy.
7. Working environment with constant temperature and cleanliness can make sure the dimensions of fittings stable for very long time.
8. Individually sealed packaging for each fitting to prevent contamination and wear.
9. Standardized work guidance system. Complete work flow control.
10. [A standardized batch management system](#) to guarantee the traceability during the whole process.

PE Gas Pipe

QUALIFICATION CERTIFICATE



Material: polyethylene

- Guarantee: more than 50 years
- Zero leak
- Low flow-resistant
- Good heat-resistant
- Sizes:
 - pipe fitting: dn 20–dn 400
 - pipe: dn 16–dn 630 pressure rate: 0.2 MPa; 0.4 MPa; 0.6MPa; 1.0MPa
- Standard:
 - GB 15558.1–2003 ISO 4437: 1997 for PE gas pipe
 - GB 15558.2–2005 ISO 8085–2: 2001 for PE gas pipe fitting
 - GB 15558.3–2008 ISO 10933: 1997 for valve
 - GB 26255.1–2010 ISO 10838–1: 2000 for PE/Steel transition joint dn≤63mm
 - GB 26255.2–2010 ISO 10838–2: 2000 for PE/Steel transition joint dn > 63mm
- Applications: gas transportation
- Advantages:
 - Very good resistance to prolonged stresses combined with pressure and temperature
 - Long service lifespan, testified nontoxic and sanitary
 - Good resistance to kinds of chemical agents
 - Less noise flow rate than traditional pipes/pipe fittings
 - Recyclable, friendly to the environment
 - Simple and reliable connection, such as socket fusion, flange connection, electro fusion/thermal fusion connection.
 - Lightweight and flexible for easier and more cost-effective installation
 - Superior strength and resistance to slow cracks
 - Resist weather, abrasion, UV degradation, aggressive soils and corrosion
 - Best after-service



PE80

dn(mm)	Min.mm SDR	
	PN, MPa	
	SDR11 PN ≤ 0.5MPa	SDR17 PN ≤ 0.3MPa
16	3.0	-
20	3.0	-
25	3.0	-
32	3.0	3.0
40	3.7	3.0
50	4.6	3.0
63	5.8	3.8
75	6.8	4.5
90	8.2	5.4
110	10.0	6.6
125	11.4	7.4
140	12.7	8.3
160	14.6	9.5
180	16.4	10.7
200	18.2	11.9
225	20.5	13.4
250	22.7	14.8
280	25.4	16.6
315	28.6	18.7
355	32.2	21.1
400	36.4	23.7
450	40.9	26.7
500	45.5	29.7
560	50.9	33.2
630	57.3	37.4

PE100

dn(mm)	Min.mm SDR	
	PN, MPa	
	SDR11 PN ≤ 0.7MPa	SDR17 PN ≤ 0.4MPa
16	3.0	-
20	3.0	-
25	3.0	-
32	3.0	3.0
40	3.7	3.0
50	4.6	3.0
63	5.8	3.8
75	6.8	4.5
90	8.2	5.4
110	10.0	6.6
125	11.4	7.4
140	12.7	8.3
160	14.6	9.5
180	16.4	10.7
200	18.2	11.9
225	20.5	13.4
250	22.7	14.8
280	25.4	16.6
315	28.6	18.7
355	32.2	21.1
400	36.4	23.7
450	40.9	26.7
500	45.5	29.7
560	50.9	33.2
630	57.3	37.4

Battenfeld-cincinnati

Automatic Extrusion Lines



Motan dehumidifying dryer made in Germany



High precision automatic system



INOEX weight machine made in Germany



INOEX ultrasonic wall thickness test machine made in Germany



Dust free caps

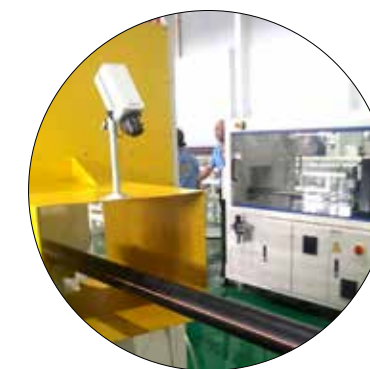

24 hours monitor (raw materials、 sizes、 wall thickness)

Please choose the same brand

GAS PIPE FITTINGS for safety Guarantee

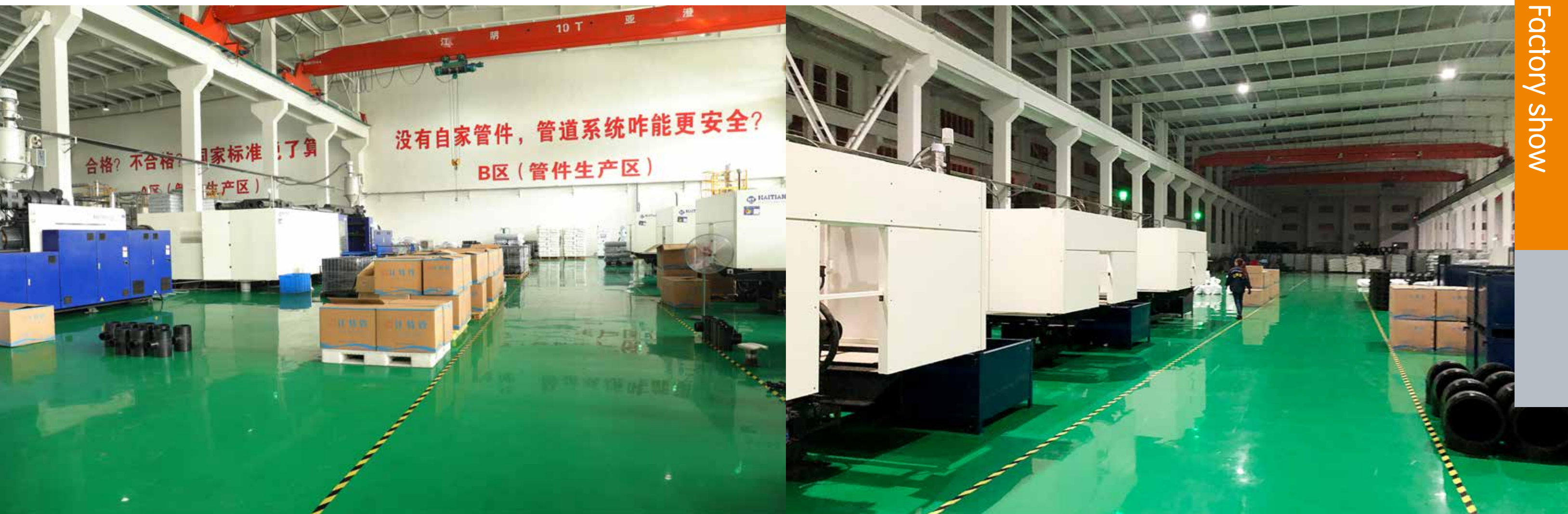

Haitian Injection machines



Accurate processing to ensure the fittings sizes



Strict resistance test of each electrofusion fitting



Raw materials dry and dehumidify to ensure the quality



Moulds area



Borealis (Borouge)

Electrofusion Fittings Series



Electrofusion Coupler

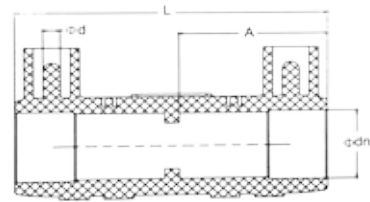

(Specifications) dn	L	A	d
20	84	40	4.7
25	89	43	4.7
32	89	43	4.7
40	99	47	4.7
50	111	53	4.7
63	112	54	4.7
75	131	63	4.7
90	134	64	4.7
110	149	72	4.7
125	170	82	4.7
160	184	90	4.7
200	210	102	4.7
250	220	106	4.7
315	230	111	4.7
355	265	130	4.7
400	310	150	4.7



Electrofusion 90° Elbow

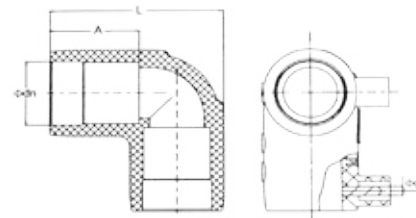

(Specifications) dn	L	A	d
25	79	42	4.7
32	83	44	4.7
40	97	47	4.7
50	113	53	4.7
63	129	55	4.7
75	150	64	4.7
90	170	66	4.7
110	200	73	4.7
125	225	80	4.7
160	268	89	4.7
200	320	105	4.7
250	395	113	4.7
315	485	129	4.7
400	590	140	4.7
355	265	130	4.7
400	310	150	4.7



Electrofusion Reducer

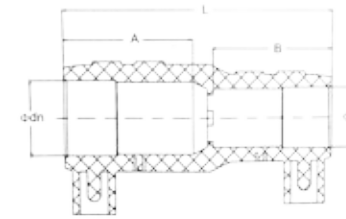

(Specifications) dn × dn1	L	A	B	d
32 × 20	96	44	44	4.7
32 × 25	96	46	43	4.7
40 × 20	106	51	45	4.7
40 × 25	105	50	48	4.7
50 × 25	115	54	42	4.7
50 × 32	114	52	42	4.7
50 × 40	115	53	42	4.7
63 × 25	120	60	41	4.7
63 × 32	120	61	44	4.7
63 × 40	120	61	49	4.7
63 × 50	120	61	52	4.7
75 × 50	131	64	53	4.7
75 × 63	131	65	55	4.7
90 × 50	140	70	53	4.7
90 × 63	140	70	60	4.7
90 × 75	145	70	64	4.7
110 × 63	156	78	60	4.7
110 × 75	156	79	65	4.7
110 × 90	156	79	67	4.7
160 × 90	197	79	74	4.7
160 × 110	197	96	77	4.7
160 × 125	197	91	83	4.7
200 × 110	210	97	80	4.7
200 × 160	210	95	85	4.7
250 × 110	230	95	80	4.7
250 × 160	230	100	90	4.7
250 × 200	230	110	100	4.7
315 × 200	240	110	100	4.7
315 × 250	240	100	100	4.7
400 × 250	260	110	105	4.7
400 × 315	260	110	105	4.7



Electrofusion Tee

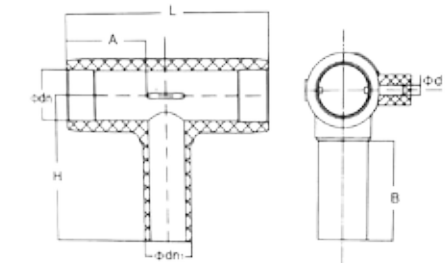

(Specifications) dn × dn1 × dn	L	A	B	H	d
20 × 20 × 20	102	41	44	66	4.7
25 × 25 × 25	106	44	49	74	4.7
32 × 32 × 32	113	43	50	80	4.7
40 × 40 × 40	128	48	58	93	4.7
50 × 50 × 50	147	53	59	100	4.7
63 × 63 × 63	162	55	64	114	4.7
75 × 75 × 75	189	63	71	130	4.7
90 × 90 × 90	206	66	80	143	4.7
110 × 110 × 110	236	73	84	163	4.7
125 × 125 × 125	255	80	85	174	4.7
160 × 160 × 160	310	90	98	210	4.7
200 × 200 × 200	360	100	105	238	4.7
250 × 250 × 250	410	100	115	290	4.7
315 × 315 × 315	520	125	115	323	4.7
400 × 400 × 400	600	125	115	394	4.7



Electrofusion 45° Elbow

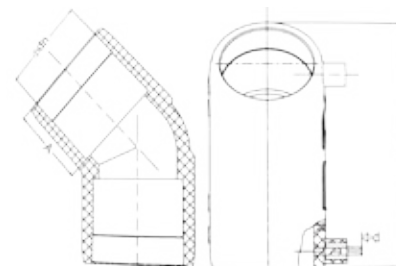

(Specifications) dn	L	A	d
50	130	50	4.7
63	160	56	4.7
90	204	67	4.7
110	234	73	4.7
160	290	96	4.7
200	330	100	4.7
250	420	115	4.7
315	170	130	4.7
400	580	140	4.7



(Electrofusion Reducing Tee)

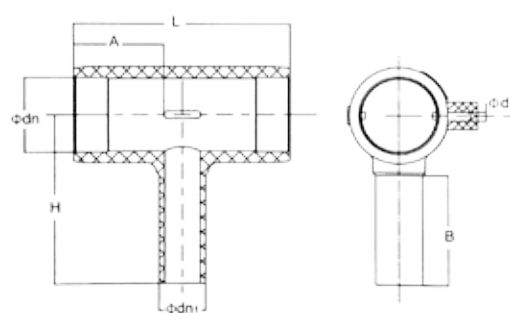

(Specifications) dn × dn1 × dn	L	A	B	H	d
25 × 20 × 25	101	43	48	75	4.7
32 × 20 × 32	101	42	49	78	4.7
32 × 25 × 32	107	43	49	79	4.7
40 × 25 × 40	118	47	59	96	4.7
40 × 32 × 40	125	49	58	91	4.7
50 × 25 × 50	127	53	59	100	4.7
50 × 32 × 50	133	53	59	100	4.7
50 × 40 × 50	138	53	61	100	4.7
63 × 25 × 63	130	55	61	110	4.7
63 × 32 × 63	138	55	60	110	4.7
63 × 40 × 63	144	56	60	110	4.7
63 × 50 × 63	151	55	61	110	4.7
75 × 40 × 75	160	62	70	130	4.7
75 × 50 × 75	168	60	69	130	4.7
75 × 63 × 75	179	62	68	128	4.7
90 × 32 × 90	158	66	81	145	4.7
90 × 40 × 90	166	67	81	147	4.7
90 × 50 × 90	173	66	79	145	4.7
90 × 63 × 90	185	67	80	145	4.7
90 × 75 × 90	195	66	80	145	4.7
110 × 32 × 110	173	74	81	160	4.7
110 × 40 × 110	179	74	82	160	4.7
110 × 50 × 110	186	74	82	160	4.7
110 × 63 × 110	198	74	80	160	4.7

(Specifications) dn × dn1 × dn	L	A	B	H	d
110 × 75 × 110	210	74	81	160	4.7
110 × 90 × 110	220	74	80	160	4.7
125 × 90 × 125	255	80	85	174	4.7
125 × 110 × 125	255	80	85	164	4.7
160 × 63 × 160	230	87	80	195	4.7
160 × 75 × 160	243	88	100	210	4.7
160 × 90 × 160	250	88	99	210	4.7
160 × 110 × 160	271	89	100	210	4.7
160 × 125 × 160	285	88	100	210	4.7
200 × 90 × 200	355	100	75	210	4.7
200 × 110 × 200	355	100	75	210	4.7
200 × 160 × 200	355	100	90	220	4.7
250 × 110 × 250	405	100	95	258	4.7
250 × 160 × 250	405	100	110	272	4.7
250 × 200 × 250	405	100	110	282	4.7
315 × 110 × 315	520	125	95	293	4.7
315 × 160 × 315	520	125	95	296	4.7
315 × 200 × 315	520	125	110	308	4.7
315 × 250 × 315	520	125	110	312	4.7
400 × 110 × 400	600	125	115	4.7	4.7
400 × 160 × 400	600	125	115	4.7	4.7
400 × 200 × 400	600	125	115	4.7	4.7
400 × 250 × 400	600	125	115	4.7	4.7
400 × 315 × 400	600	125	115	4.7	4.7



Electrofusion End Cap

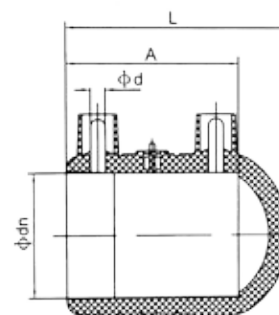

(Specifications) dn	L	A	d
32	69	56	4.7
40	75	62	4.7
50	76	62	4.7
63	80	62	4.7
90	92	72	4.7
110	99	71	4.7



Electrofusion Repair Saddle

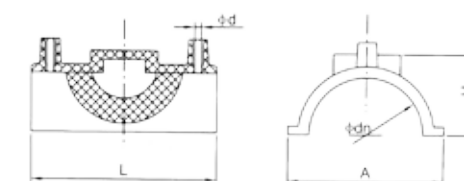

(Specifications) dn	L	A	H	d
110	145	160	60	4.7
160	190	230	78	4.7
200	190	235	90	4.7
250	190	300	65	4.7
315	190	300	75	4.7



Electrofusion Branch Saddle

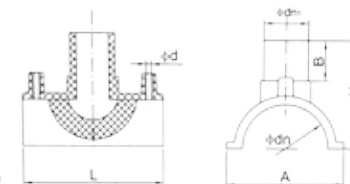

(Specifications) dn × dn1	L	A	B	H	d
63 × 32	110	100	45	80	4.7
90 × 63	145	150	80	145	4.7
110 × 32	145	160	80	145	4.7
110 × 63	190	160	80	145	4.7
160 × 63	190	230	100	185	4.7
160 × 90	190	230	100	185	4.7
200 × 63	190	235	110	185	4.7
200 × 90	190	235	115	195	4.7
250 × 63	190	300	115	195	4.7
250 × 90	190	300	115	195	4.7
315 × 63	190	300	115	195	4.7
315 × 90	190	300	120	200	4.7



Electrofusion Tapping Saddle

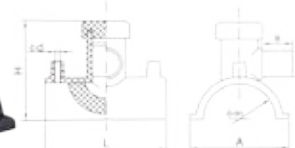

(Specifications) dn	L	A	B	H	d
63 × 32	110	104	50	129	4.7
90 × 25	140	130	75	185	4.7
90 × 50	140	130	75	185	4.7
90 × 63	140	130	75	185	4.7
110 × 20	130	155	55	145	4.7
110 × 25	130	155	55	145	4.7
110 × 32	130	155	55	145	4.7
110 × 50	145	160	75	175	4.7
110 × 63	145	160	75	175	4.7
160 × 63	190	240	85	225	4.7
160 × 90	190	240	160	225	4.7
200 × 63	190	255	85	215	4.7
200 × 90	190	255	160	215	4.7
250 × 63	190	265	85	215	4.7
250 × 90	190	265	160	215	4.7
315 × 63	190	310	85	240	4.7
315 × 90	190	310	160	240	4.7



Syphon tank

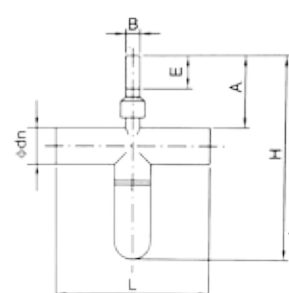

(Specifications) dn	L	A	B	E	H	d
63	230	230	32	95	600	4.7
90	280	230	32	95	700	4.7
110	380	230	32	95	770	4.7
160	430	230	32	95	770	4.7
200	420	230	32	95	700	4.7
250	520	230	32	95	780	4.7
315	620	230	32	95	890	4.7

Butt Fusion Fittings Series



Reducer

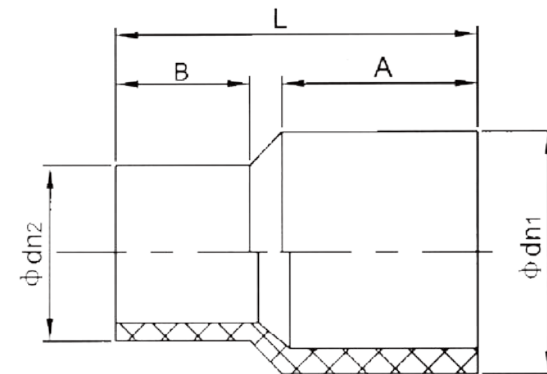

SDR11				
(Specifications) dn1xdn2	L	A	B	
63 × 25	159	63	55	
63 × 32	158	63	55	
63 × 40	157	63	57	
63 × 50	162	63	58	
75 × 32	163	70	58	
75 × 40	163	70	59	
75 × 50	163	70	57	
75 × 63	168	70	63	
90 × 40	167	79	49	
90 × 50	175	79	55	
90 × 63	177	79	63	
90 × 75	184	79	70	
110 × 40	180	89	60	
110 × 50	180	89	60	
110 × 63	185	89	63	
110 × 75	188	89	70	
110 × 90	190	89	79	
125 × 63	193+3	87	63	
125 × 90	198+3	87	79	
125 × 110	209	87	82	
140 × 90	232	92	79	
140 × 110	232	92	82	
160 × 32	210	98	70	
160 × 63	202	98	63	
160 × 75	207	112	70	
160 × 90	217	98	79	
160 × 110	215	98	82	
160 × 125	224	98	87	
180 × 90	240	105	80	
180 × 110	228	105	82	
180 × 125	240	105	87	
180 × 160	240	105	98	
200 × 63	227	112	63	

SDR11				
(Specifications) dn1xdn2	L	A	B	
200 × 90	230	112	80	
200 × 110	230	112	82	
200 × 125	230	112	87	
200 × 160	240	112	98	
200 × 180	242	112	105	
225 × 90	237	110	79	
225 × 110	250	110	82	
225 × 160	258	110	98	
225 × 180	250	110	88	
225 × 200	255	115	88	
250 × 90	230	110	88	
250 × 110	237	110	88	
250 × 125	230	110	88	
250 × 160	245	110	90	
250 × 180	248	110	100	
250 × 200	250	110	105	
250 × 225	235	110	85	
280 × 160	256	110	88	
280 × 225	250	110	85	
280 × 250	248	110	82	
315 × 90	255	118	90	
315 × 110	255	118	92	
315 × 160	256	118	92	
315 × 180	256	118	94	
315 × 200	258	118	94	
315 × 225	255	117	95	
315 × 250	255	117	95	
315 × 280	255	120	104	
355 × 280	285	115	110	
400 × 200	285	110	110	
400 × 250	285	110	110	
400 × 315	285	110	110	
400 × 355	285	110	110	



Reducing Tee

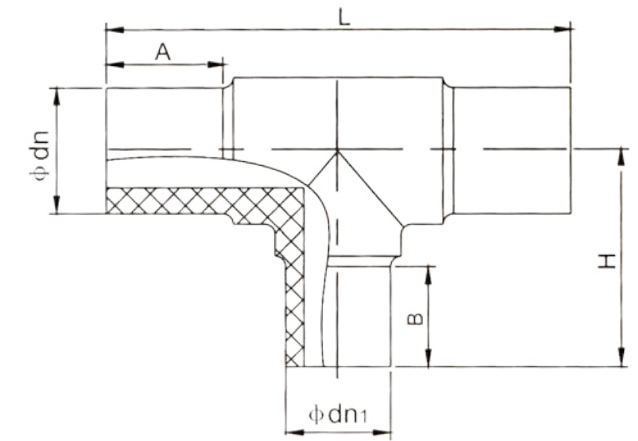

SDR11				
(Specifications) dnxdn1xdn	L	A	B	H
50 × 32 × 50	159	55	45	79
63 × 25 × 63	171	63	44	90
63 × 32 × 63	178	63	45	90
63 × 40 × 63	185	63	49	85
63 × 50 × 63	184	63	55	100
75 × 32 × 75	195	70	45	95
75 × 40 × 75	200	70	49	99
75 × 50 × 75	212	70	55	105
75 × 63 × 75	223	70	63	113
90 × 32 × 90	212	79	45	100
90 × 40 × 90	219	79	50	105
90 × 50 × 90	230	79	55	112
90 × 63 × 90	243	79	63	118
90 × 75 × 90	255	79	70	126
110 × 32 × 110	220	82	50	115
110 × 40 × 110	230	82	50	128
110 × 50 × 110	238	82	55	135
110 × 63 × 110	250	82	63	138
110 × 75 × 110	264	82	70	145
110 × 90 × 110	275	82	79	152
125 × 63 × 125	260	87	63	139
125 × 75 × 125	273	87	70	145
125 × 90 × 125	292	87	79	157
125 × 110 × 125	310	87	82	155
140 × 110 × 140	315	92	82	160
140 × 125 × 140	333	92	87	175
160 × 63 × 160	275	98	63	163
160 × 75 × 160	288	98	70	173
160 × 90 × 160	300	98	79	185
160 × 110 × 160	335	98	82	195
160 × 125 × 160	325	98	87	192
160 × 140 × 160	347	98	92	197
180 × 90 × 180	340	105	79	190
180 × 110 × 180	355	105	82	190
180 × 125 × 180	365	105	87	202
180 × 140 × 180	380	105	92	196
180 × 160 × 180	400	105	98	202
200 × 63 × 200	307	112	63	181
200 × 75 × 200	315	112	70	182
200 × 90 × 200	334	112	79	190

SDR11				
(Specifications) dnxdn1xdn	L	A	B	H
200 × 110 × 200	356	112	82	200
200 × 125 × 200	380	112	87	204
200 × 160 × 200	420	112	98	210
225 × 90 × 225	360	120	79	220
225 × 110 × 225	370	120	82	215
225 × 160 × 225	422	120	98	230
225 × 180 × 225	430	95	86	195
250 × 90 × 250	394	130	79	225
250 × 110 × 250	415	130	82	230
250 × 125 × 250	410	129	87	235
250 × 160 × 250	465	130	98	245
250 × 180 × 250	464	129	102	245
250 × 200 × 250	505	130	112	255
280 × 90 × 280	406	139	79	245
280 × 110 × 280	410	139	82	250
280 × 125 × 280	427	139	87	255
280 × 160 × 280	459	139	98	270
280 × 200 × 280	520	140	112	268
280 × 225 × 280	545	147	127	285
280 × 250 × 280	570	140	130	285
315 × 90 × 315	425	150	79	265
315 × 110 × 315	437	150	82	265
315 × 160 × 315	489	145	105	280
315 × 180 × 315	450	118	100	285
315 × 200 × 315	550	150	112	285
315 × 225 × 315	450	95	100	275
315 × 250 × 315	580	150	130	307
315 × 280 × 315	582	140	110	320
400 × 200 × 400	670	130	150	380
400 × 250 × 400	670	130	150	380
400 × 315 × 400	675	160	150	380
400 × 355 × 400	675	148	130	374



Tee

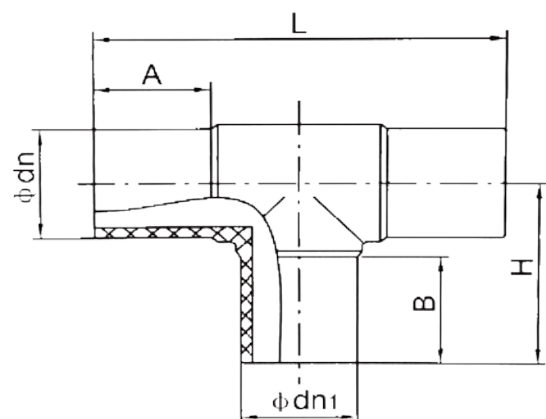

SDR11				
dn x dn1 x dn dn1 x dn2 x dn1	L	A	B	H
50 x 50 x 50	175	50	50	88
63 x 63 x 63	210	63	63	105
75 x 75 x 75	240	70	70	119
90 x 90 x 90	272	79	79	138
110 x 110 x 110	295	82	82	145
125 x 125 x 125	319	87	87	159
140 x 140 x 140	345	92	92	178
160 x 160 x 160	370	98	98	191
180 x 180 x 180	437	105	105	225
200 x 200 x 200	440	112	112	226
225 x 225 x 225	488	120	120	245
250 x 250 x 250	555	130	130	280
280 x 280 x 280	600	139	139	310
315 x 315 x 315	650	150	150	333
355 x 355 x 355	740	165	165	355
400 x 400 x 400	675	110	120	380



Elbow 90°

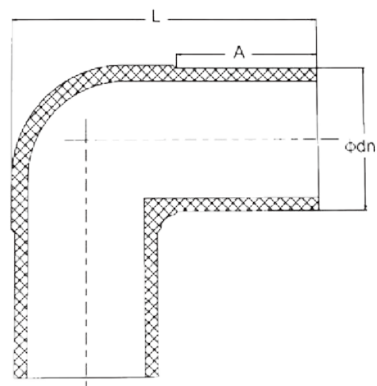

SDR11		
(Specifications) dn	L	A
50	119	55
63	135	63
75	155	70
90	180	79
110	205	82
125	220	87
140	241	82
160	265	98
180	295	105
200	335	112
225	367	120
250	400	130
280	423	139
315	488	150
355	540	165
400	610	180



Straight Cross

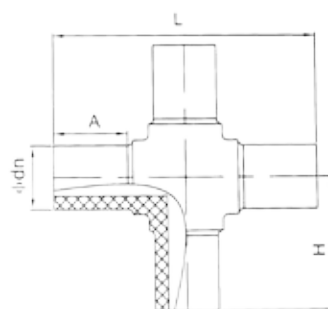

SDR11			
(Specifications) dn	L	A	H
63	230	63	115
90	295	79	147
110	380	82	190
160	430	98	215
200	420	90	210



End Cap

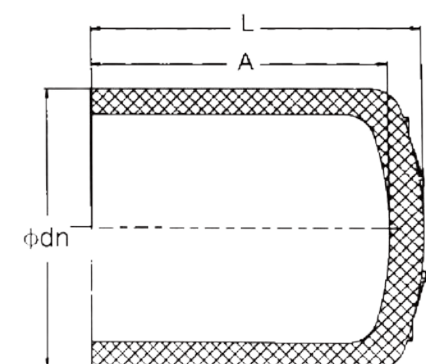

SDR11		
(Specifications) dn	L	A
20	47	43
25	47	41
32	54	48
40	72	62
50	74	65
63	77	63
75	82	70
90	95	79
110	98	82
125	106	87
140	110	92
160	118	98
180	145	112
200	130	112
225	146	120
250	153	130
280	166	140
315	185	150
400	215	150

PE/Steel Transition Fittings Series



Flange adaptor (Stub End)

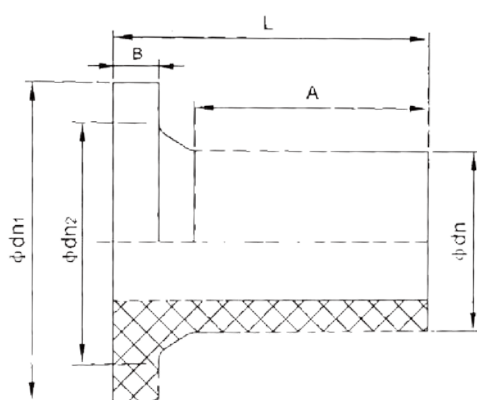

SDR11				
(Specifications) dnxdn1	dn1	L	A	B
20	45	84	63	7
25	58	84	61	8
32	68	84	61	10
40	78	79	61	12
50	88	84	67	12
63	102	85	68	13
75	122	94	75	14
90	138	98	75	17
110	158	103	91	19
125	158	127	102	21
140	188	127	97	22
160	212	135	100	26
180	212	135	100	30
200	268	155	112	35
225	268	145	105	30
250	320	160	118	32
280	320	150	105	35
315	370	175	130	35
355	430	170	125	35
400	482	175	135	34



Steel Threaded PE Transition Joint

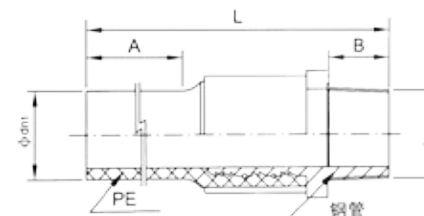

(Specifications)		PE dn1	brass dn2	L	A	B	brass inch
32 × 1"	Grade A	32	11	170	80	25	1"
40 × 1 1/4"	Grade A	40		170	80	25	1 1/4"
50 × 1 1/2"	Grade A	50		170	80	25	1 1/2"
63 × 2"	Grade A	63		170	80	25	2"



Elbow 45°

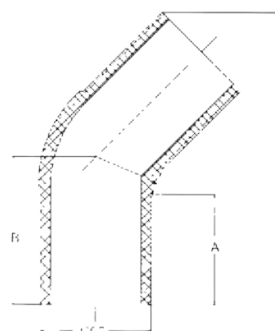

SDR11			
(Specifications) dn	L	A	B
50	160	50	83
63	162	63	85
75	190	70	100
90	205	79	104
110	234	82	120
125	246	87	124
140	275	92	134
160	302	98	145
180	340	105	155
200	370	112	170
225	390	120	170
250	420	130	194
280	460	140	215
315	495	150	228
355	530	145	235
400	580	160	270



PE/Steel Transition Joint

(Specifications) dn	
25 × 3/4"	Grade A
32 × 3/4"	Grade A
32 × 1"	Grade A
40 × 1"	Grade A
40 × 1 1/4"	Grade A
50 × 1 1/2"	Grade A
63 × 1 1/2"	Grade A
63 × 2"	Grade A

PE Ball Valve Series



PE/Steel Transition Pipe

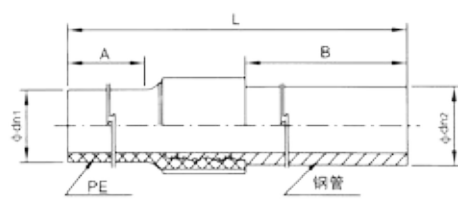

Specifications dn1xdn2	PE dn1	Steel dn2	L	A	B	Steel inch	Steel dn	
25 × 3/4"	Grade A	25	27	395	95	225	3/4"	20
32 × 3/4"	Grade A	32	27	405	105	225	3/4"	20
32 × 1"	Grade A	32	34	405	105	225	1"	25
40 × 1"	Grade A	40	34	405	110	225	1"	25
40 × 1 1/4"	Grade A	40	42	405	115	225	1 1/4"	32
50 × 1 1/2"	Grade A	50	48	410	115	225	1 1/2"	40
63 × 1 1/2"	Grade A	63	48	410	115	225	1 1/2"	40
63 × 2"	Grade A	63	57	410	115	225	2"	50
63 × 2"	Grade A	63	60	410	115	225	2"	50
75 × 2 1/2"	Grade A	75	76	550	100	355	2 1/2"	63
90 × 2 1/2"	Grade A	90	76	535	100	355	2 1/2"	63
90 × 3"	Grade A	90	89	540	95	355	3"	80
110 × 3"	Grade A	110	89	550	125	355	3"	80
110 × 4"	Grade A	110	108	550	105	355	4"	100
160 × 6"	Grade A	160	159	575	160	325	6"	150
200	Grade A	200	203	600	165	345	--	--
200	Grade A	200	219	600	150	345	--	--
250	Grade A	250	245	600	180	360	--	--
250	Grade A	250	273	680	200	370	--	--
315	Grade A	315	299	680	205	370	--	--
315	Grade A	315	325	680	245	425	--	--



(PN10) Plastic Coated Flange Plate

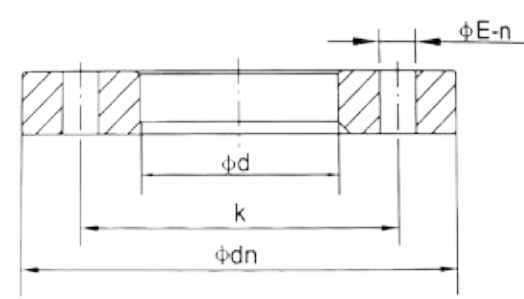

(Specifications) dn	OD	d middle hole	K hole distance	E hole diameter	n hole number	bolt	
20	Grade A	95	27	65	14	4	M12
25	Grade A	105	32	75	14	4	
32	Grade A	115	39	85	14	4	
40	Grade A	135	47	100	18	4	M16
50	Grade A	145	57	110	18	4	
63	Grade A	160	70	125	18	4	
75	Grade A	190	81	145	18	4	
90	Grade A	195	97	160	18	8	
110	Grade A	215	116	180	18	8	
125	Grade A	215	135	180	18	8	M20
140	Grade A	245	150	210	18	8	
160	Grade A	280	170	240	22	8	
180	Grade A	280	190	240	22	8	
200	Grade A	335	222	295	22	8	
225	Grade A	335	235	295	22	8	
250	Grade A	390	276	350	22	8	M24
280	Grade A	390	292	350	22	8	
315	Grade A	440	328	400	22	8	
355	Grade A	500	380	460	22	16	
400	Grade A	565	430	515	26	16	



PE/Steel Transition Bend Pipe

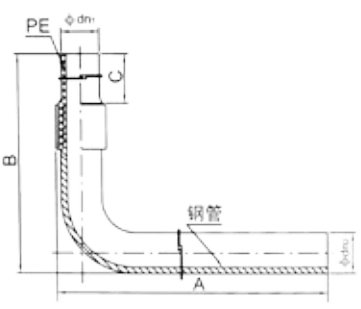

(Specifications) dn1xdn2	PE dn1	Steel dn2	L	A	B	Steel inch	Steel dn	
25 × 3/4"	Grade A	25	27	740	410	80	3/4"	20
32 × 1"	Grade A	32	34	740	410	80	1"	25
40 × 1"	Grade A	40	34	740	410	80	1"	25
40 × 1 1/4"	Grade A	40	42	740	410	80	1 1/4"	32
50 × 1 1/2"	Grade A	50	48	740	410	80	1 1/2"	40
63 × 1 1/2"	Grade A	63	48	740	430	80	1 1/2"	40
63 × 2"	Grade A	63	57	740	430	80	2"	50
63 × 2"	Grade A	63	60	740	430	80	2"	50



PE Ball Valves

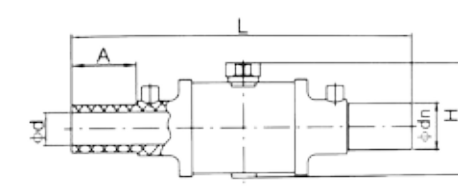

(Specifications) dn	L	A	H	d
32	510	55	205	25
50	485	90	200	41
63	510	100	200	49
90	660	110	325	70
110	660	115	325	87
160	770	115	420	126
200	785	125	430	158
250	920	130	485	204
315	985	140	585	250

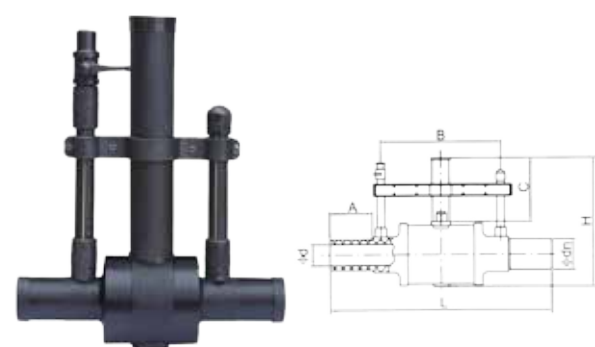

One-purge Ball Valves

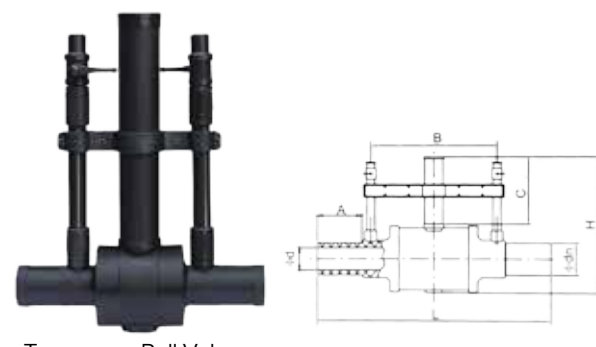

Two-purge Ball Valves

(Specifications) dn	L	A	B	C	H	d
63	520	100	235	520	640	49
90	660	110	330	590	835	70
110	680	115	330	590	830	87
160	750	115	435	590	900	126
200	780	125	435	600	935	158
250	920	130	540	600	1070	204
315	985	140	585	700	1180	250

(Specifications) dn	L	A	B	C	H	d
63	520	100	235	520	640	49
90	660	110	330	590	835	70
110	680	115	330	590	830	87
160	750	115	435	590	900	126
200	780	125	435	600	935	158
250	920	130	540	600	1070	204
315	985	140	585	700	1180	250

Parts of Raw Materials Purchase Orders

Sales Contract

Customer name: Jiangte Polytron Technologies Inc. Number 152 Xichang Rd Wuji 200000 China

Delivery address: Jiangte Polytron Technologies Inc. Number 152 Xichang Rd Wuji 200000 China

Customer number: 111911 | Order reference: 320002193919.26.2016 | Your reference: WY180216 | We reference: Vienna Huang

Material: Borouge HD2400S HD polyethylene | Quantity: 280.900 MT | Price per unit: 1,780.00 | Value: 499,260.00

Total Net Weight: 280.900 MT

Net value: 499,260.00 | Total: 499,260.00

To Delivery date: Within Jun 2017
 2) Packing: 25kg bags per pallet
 3) Origin: UAE
 Loading port: Any port of Hongkong
 4) Payment:

Order subject to Borouge General Sales Terms and

订单号 ORDER No: FTZ1709(A19003)Rev.1

买方 BUYER: 江特科技股份有限公司 (JIANGTE POLYTRON TECHNOLOGIES INC)

卖方 SELLER: 沙伯基础(上海)实业有限公司 (SABIC (Shanghai) Industry Co., Ltd)

数量 (包): 499.000 | 单位: USD / TO | 总价: 687,260.00

特别指示 (如有):
 信用证开证日期 (早于) L/C issuance date (BEFORE): 29.09.2017
 最迟装运日期 (早于) Latest Shipment Date (BEFORE): 03.11.2017
 信用证到期日 L/C Expiry Date: 24.11.2017

Factory show

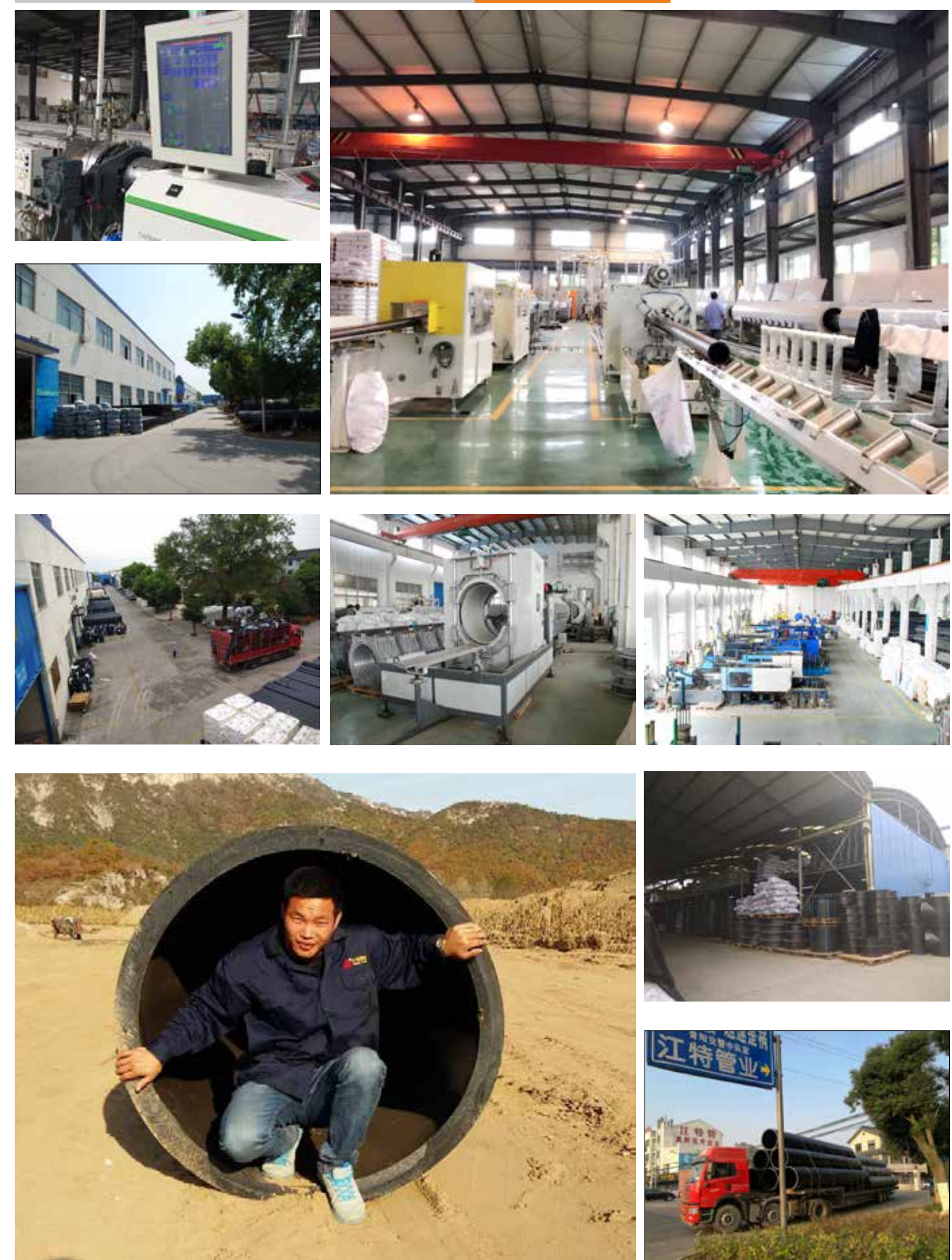

Jiangte's CNAS Testing Center



Parts Of Jiangte's Testing Machines





江特管

用心做好管

WE SUPPLY

PE100、PE80、PE100-RC GAS PIPE
ELECTROFUSION PE FITTINGS
BUTT FUSION PE FITTINGS
PE BALL VALVE
STEEL AND PLASTIC TRANSITION

OUR PARTNERS

battenfeld-cincinnati 
巴顿菲尔辛辛那提

بروج 
Borouge
北欧化工 (博禄)

iNOEX
伊诺艾克斯

Krauss Maffei
克劳斯玛菲机械

motan[®]
摩丹

TOTAL
道达尔

Jiang Te Polytron Technologies Inc

Address: No. 1349, Xicheng Road, Qingyang Town,
Jiangyin, Jiangsu Province, China.

Tel: 0086-510-86511823

Fax: 0086-510-86918285

Web: www.jiangtepipe.com

E-mail: sales@jiangtepipe.com